

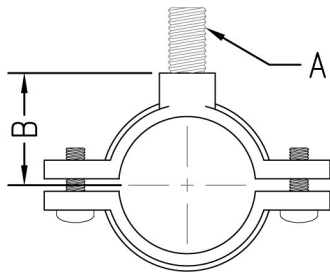

www.phd-mfg.com

# SPLIT RING HANGERS

**FIG. 512**



## COPPER TUBING EXTENSION SPLIT CLAMP

**Function:** Designed for non-insulated stationary tubing lines in either a horizontal or vertical position.

**Material:** Malleable iron

**Finish:** Copper color epoxy finish

**Approvals:** Complies with Federal Specification A-A-1192A (Type 12) and Manufacturers' Standardization Society ANSI/MSS SP-58 (Type 12) which supersedes ANSI/MSS SP-69.

**Ordering:** Specify figure number and pipe size.

Tube Size	Bolt Thread A	B			Max. Rec. Load		Wt. Each	
					lbs.	kN	lbs.	kg
3/8	(10)	3/8	9/16	(14.29)	180	(0.80)	.07	(.03)
1/2	(15)	3/8	11/16	(17.46)	180	(0.80)	.09	(.04)
3/4	(20)	3/8	7/8	(22.23)	180	(0.80)	.09	(.04)
1	(25)	3/8	1	(25.40)	180	(0.80)	.10	(.05)
1 1/4	(32)	3/8	1 1/8	(28.58)	180	(0.80)	.12	(.05)
1 1/2	(40)	3/8	1 5/16	(33.34)	180	(0.80)	.13	(.06)
2	(50)	3/8	1 1/2	(38.10)	180	(0.80)	.18	(.08)
2 1/2	(65)	1/2	1 7/8	(47.63)	300	(1.33)	.65	(.29)
3	(80)	1/2	2 1/8	(53.98)	300	(1.33)	1.00	(.45)
4	(100)	1/2	2 3/4	(69.85)	300	(1.33)	1.40	(.64)

THREADED ACCESSORIES  
CPVC STRAPS  
BAND HANGERS  
BEAM CLAMPS  
CLEVIS HANGERS  
PIPE ROLLER SUPPORTS  
SPLIT RING HANGERS  
PIPE CLAMPS  
PIPE LOAD BEAM CLAMPS  
PIPE SHIELDS, INSULATION, & SADDLES  
PIPE GUIDES & SLIDES  
WALL BRACKETS  
PIPE SUPPORTS  
STRUCTURAL ATTACHMENTS  
SEISMIC BRACING