

SPECIALTY FITTINGS



www.phd-mfg.com

FIG. 5801 & 5802

SINGLE PIPE AXLE SUPPORT FOR 1 1/4" PIPE

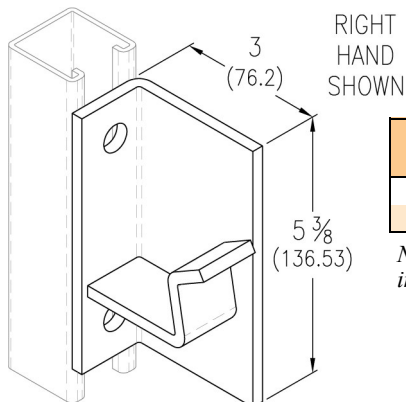

Fig. No.		Wt. Each	
		lbs.	kg
5801	RIGHT	2.25	(1.02)
5802	LEFT	2.25	(1.02)

Note: Not available in Stainless Steel.

FIG. 5803 & 5804

SINGLE PIPE AXLE SUPPORT FOR 2" PIPE

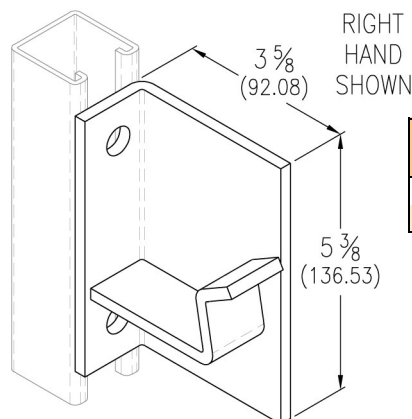
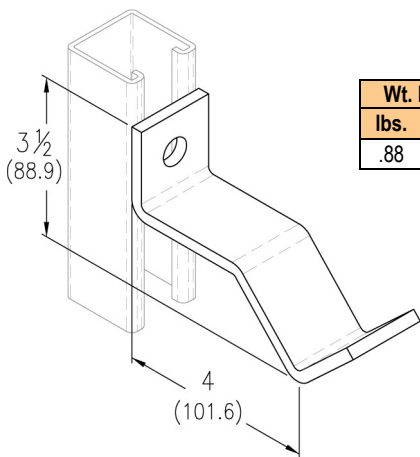

Fig. No.		Wt. Each	
		lbs.	kg
5803	RIGHT	2.46	(1.12)
5804	LEFT	2.46	(1.12)

Note: Not available in Stainless Steel.

FIG. 5821

PIPE SUPPORT BRACKET



Wt. Each	
lbs.	kg
.88	(.40)

FIG. 5825 - 5827

SERIES LADDER RUNG

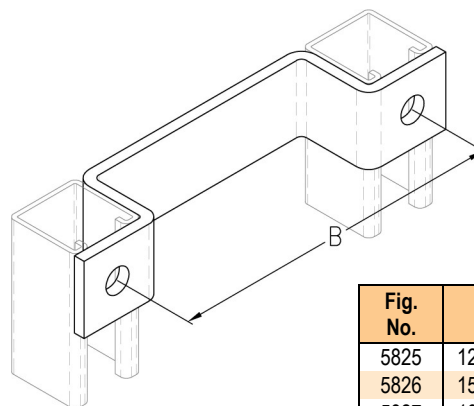

Fig. No.	B	Wt. Each	
		lbs.	kg
5825	12 (304.80)	1.76	(.80)
5826	15 (381.00)	2.02	(.92)
5827	18 (457.20)	2.34	(1.06)

FIG. 5830 - 5834

WALL LADDER BRACKET

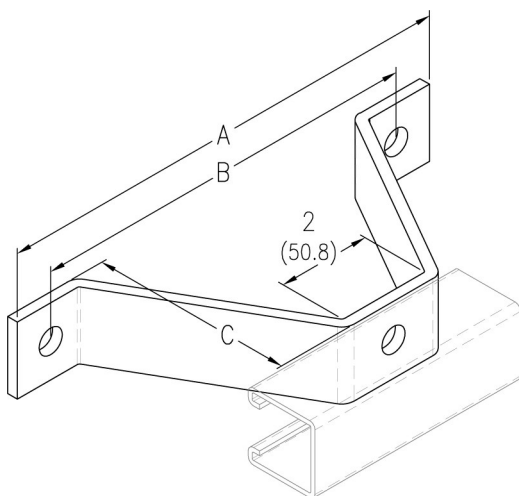

Fig. No.	A		Length B		C		Wt. Each	
							lbs.	kg
5830	7 5/8	(193.68)	6	(152.4)	2 3/8	(60.33)	1.10	(.50)
5831	9 5/8	(244.48)	8	(203.2)	4 3/8	(111.13)	1.64	(.74)
5832	11 5/8	(295.28)	10	(254.0)	6 3/8	(161.93)	2.00	(.91)
5833	13 5/8	(346.08)	12	(304.8)	8 3/8	(212.73)	2.53	(1.15)
5834	15 5/8	(396.88)	14	(355.6)	10 3/8	(263.53)	3.18	(1.44)

Note: Not available in Stainless Steel.

Standard Product Information for 1 5/8" (41.3) width series channel fittings (Unless Otherwise Noted)

Hole Diameter: 9/16" (14.3); Hole Spacing-From End: 1 3/16" (20.6); Hole Spacing-On Center: 1 7/8" (47.6); Width: 1 5/8" (41.3); Thickness: 1/4" (6.4)
 Material: Carbon steel (Type 304 or 316 Stainless Steel upon request); Finish: Electro-galvanized (hot-dip galvanized, e-coat, and powder coated upon request)
 Ordering: Specify figure number, material, and finish.

Unless otherwise specified, all dimensions on drawings and in charts are in inches and dimensions shown in parentheses are in millimeters.

CHANNEL
 PIPE & CONDUIT SUPPORTS
 STRUT NUTS & HARDWARE
 CONCRETE INSERTS
 END CAPS & CLOSURES
 FLAT PLATE FITTINGS
 90° ANGLE FITTINGS
 ANGLE FITTINGS
 "U" FITTINGS
 "Z" FITTINGS
 WING FITTINGS
 SPECIALTY FITTINGS
 TROLLEY ASSEMBLIES
 POST BASES
 BRACKETS & BRACE FITTINGS
 BEAM CLAMPS
 ROOFTOP SUPPORTS



SPECIALTY FITTINGS

FIG. 5835 - 5837
PIPE COUPLING FITTING

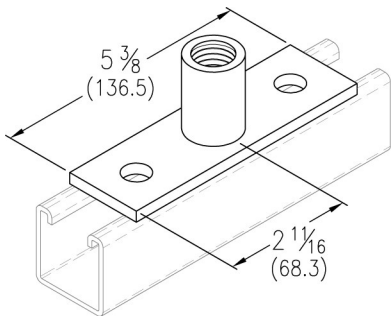

Fig. No.	Pipe Size	Wt. Each	
		lbs.	kg
5835	1/2	.77	(.35)
5836	3/4	.84	(.38)
5837	1	1.05	(.48)

Note: Not available in Stainless Steel.

FIG. 5860 & 5861
STAIR SUPPORT

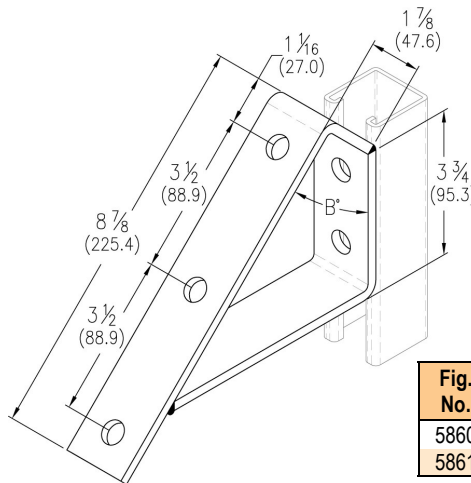
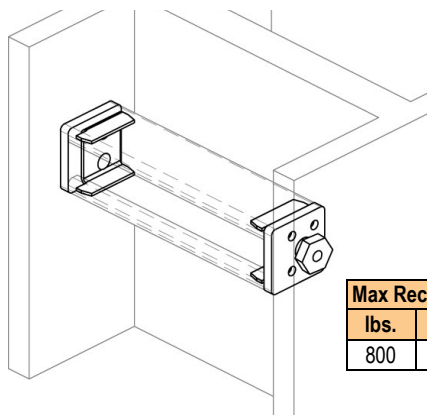

Fig. No.	Angle B	Wt. Each	
		lbs.	kg
5860	45°	2.20	(1.00)
5861	37 1/2°	2.06	(.93)

FIG. 8070

COLUMN SUPPORT FOR 1 5/8" CHANNEL



Max Rec. Load		Wt. Each	
lbs.	kN	lbs.	kg
800	(3.56)	.51	(.23)

FIG. 8075

COLUMN SUPPORT FOR 1 5/8" CHANNEL

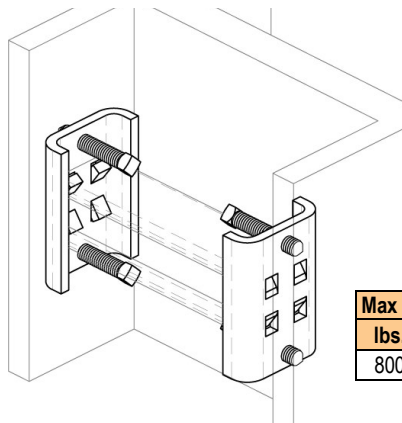

Max Rec. Load		Wt. Each	
lbs.	kN	lbs.	kg
800	(3.56)	.69	(.31)

FIG. 8076

COLUMN SUPPORT FOR 1 3/16" CHANNEL

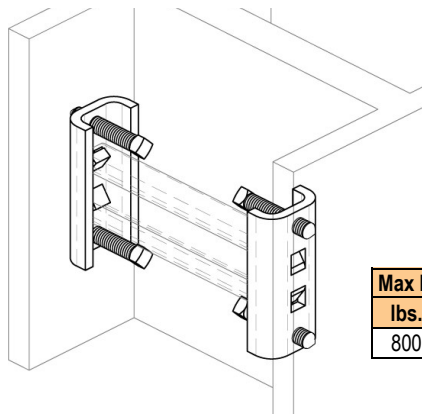

Max Rec. Load		Wt. Each	
lbs.	kN	lbs.	kg
800	(3.56)	.69	(.31)

Standard Product Information for 1 5/8" (41.3) width series channel fittings (Unless Otherwise Noted)

Hole Diameter: 9/16" (14.3); Hole Spacing-From End: 1 3/16" (20.6); Hole Spacing-On Center: 1 7/8" (47.6); Width: 1 5/8" (41.3); Thickness: 1/4" (6.4)
Material: Carbon steel (Type 304 or 316 Stainless Steel upon request); Finish: Electro-galvanized (hot-dip galvanized, e-coat, and powder coated upon request)
Ordering: Specify figure number, material, and finish.

Unless otherwise specified, all dimensions on drawings and in charts are in inches and dimensions shown in parentheses are in millimeters.