

# WING FITTINGS



## FIG. 5600 & 5601

3-HOLE CORNER CONNECTOR

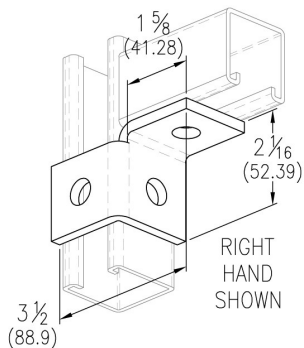

Fig. No.		Wt. Each	
		lbs.	kg
5600	RIGHT	.60	(.27)
5601	LEFT	.60	(.27)

## FIG. 5605 & 5606

4-HOLE CORNER CONNECTOR

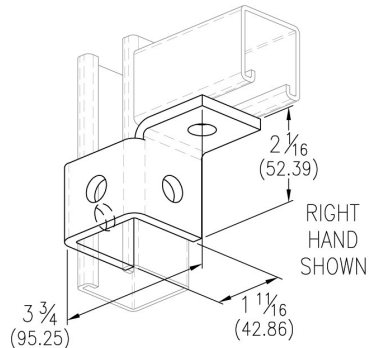

Fig. No.		Wt. Each	
		lbs.	kg
5605	RIGHT	.70	(.32)
5606	LEFT	.70	(.32)

## FIG. 5610 & 5611

5-HOLE CORNER CONNECTOR

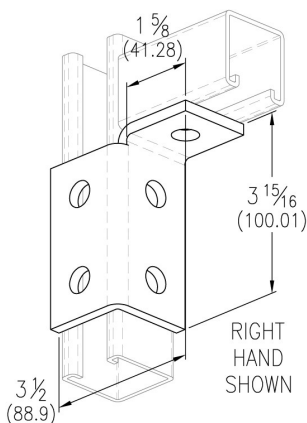

Fig. No.		Wt. Each	
		lbs.	kg
5610	RIGHT	1.00	(.45)
5611	LEFT	1.00	(.45)

## FIG. 5615 & 5616

6-HOLE CORNER CONNECTOR

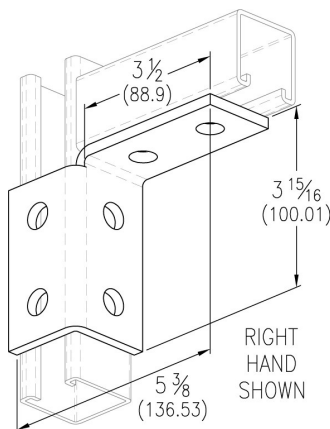

Fig. No.		Wt. Each	
		lbs.	kg
5615	RIGHT	1.20	(.54)
5616	LEFT	1.20	(.54)

## FIG. 5617 & 5618

6-HOLE GUSSETED CORNER CONNECTOR

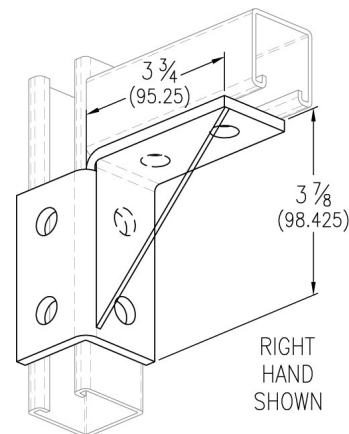
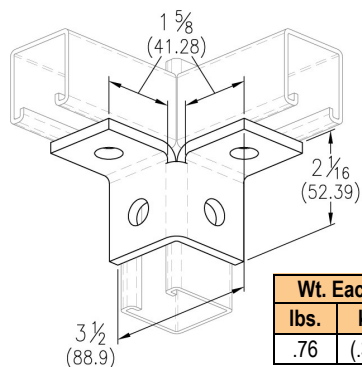

Fig. No.		Wt. Each	
		lbs.	kg
5617	RIGHT	1.76	(.8)
5618	LEFT	1.76	(.8)

## FIG. 5620

4-HOLE DOUBLE CORNER CONNECTOR



Wt. Each	
lbs.	kg
.76	(.34)

## FIG. 5625

6-HOLE DOUBLE CORNER CONNECTOR

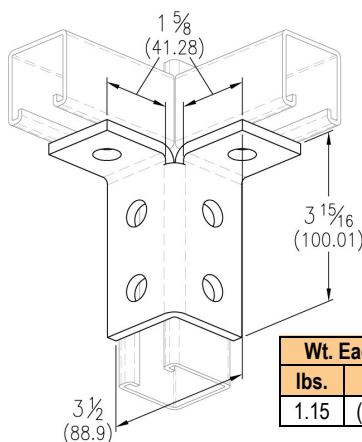

Wt. Each	
lbs.	kg
1.15	(.52)

## FIG. 5630

8-HOLE DOUBLE CORNER CONNECTOR

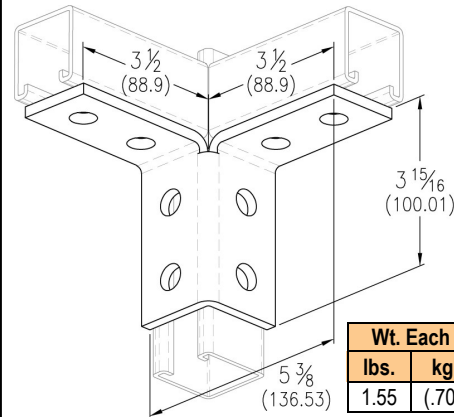

Wt. Each	
lbs.	kg
1.55	(.70)

Standard Product Information for 1 5/8" (41.3) width series channel fittings (Unless Otherwise Noted)

Hole Diameter: 9/16" (14.3); Hole Spacing-From End: 1 3/16" (20.6); Hole Spacing-On Center: 1 7/8" (47.6); Width: 1 5/8" (41.3); Thickness: 1/4" (6.4)  
 Material: Carbon steel (Type 304 or 316 Stainless Steel upon request); Finish: Electro-galvanized (hot-dip galvanized, e-coat, and powder coated upon request)  
 Ordering: Specify figure number, material, and finish.

Unless otherwise specified, all dimensions on drawings and in charts are in inches and dimensions shown in parentheses are in millimeters.

CHANNEL  
 PIPE & CONDUIT SUPPORTS  
 STRUT NUTS & HARDWARE  
 CONCRETE INSERTS  
 END CAPS & CLOSURES  
 FLAT PLATE FITTINGS  
 90° ANGLE FITTINGS  
 ANGLE FITTINGS  
 "U" FITTINGS  
 "Z" FITTINGS  
 WING FITTINGS  
 SPECIALTY FITTINGS  
 TROLLEY ASSEMBLIES  
 POST BASES  
 BRACKETS & BRACE FITTINGS  
 BEAM CLAMPS  
 ROOFTOP SUPPORTS



www.phd-mfg.com

# WING FITTINGS

**FIG. 5635**

5-HOLE DOUBLE WING CONNECTOR

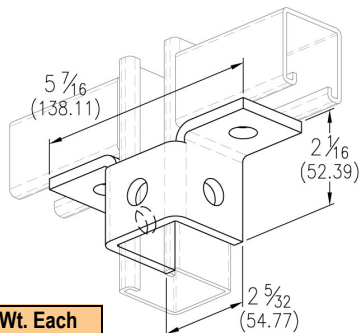

Wt. Each	
lbs.	kg
.93	(.42)

**FIG. 5640**

8-HOLE DOUBLE WING CONNECTOR

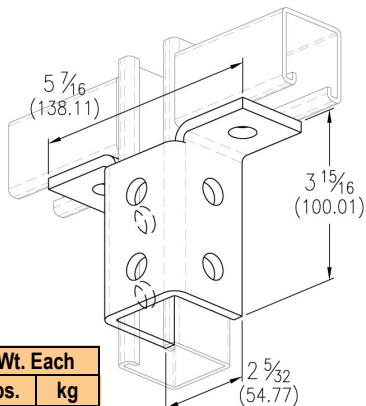

Wt. Each	
lbs.	kg
1.77	(.80)

**FIG. 5645**

10-HOLE DOUBLE WING CONNECTOR

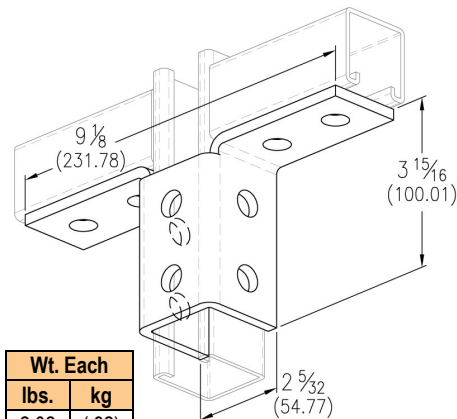

Wt. Each	
lbs.	kg
2.02	(.92)

**FIG. 5650**

6-HOLE TRIPLE WING CONNECTOR

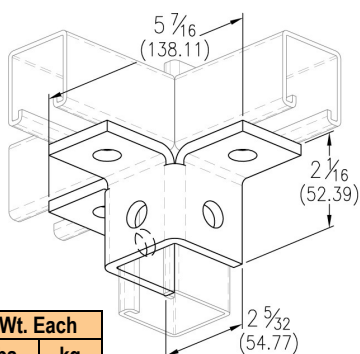

Wt. Each	
lbs.	kg
1.07	(.49)

**FIG. 5655**

12-HOLE TRIPLE WING CONNECTOR

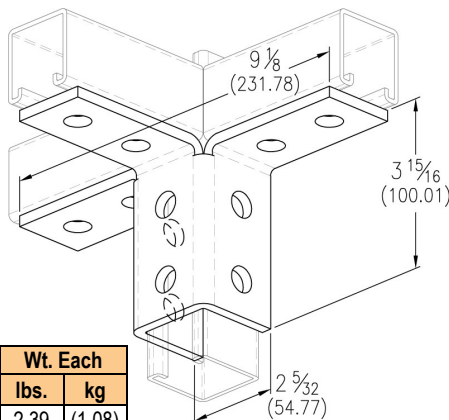

Wt. Each	
lbs.	kg
2.39	(1.08)

**FIG. 5660**

9-HOLE TRIPLE WING CONNECTOR

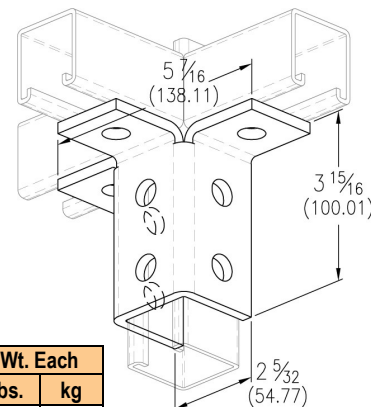

Wt. Each	
lbs.	kg
1.93	(.88)

**FIG. 5665**

8-HOLE GUSSETED DOUBLE CORNER CONNECTOR

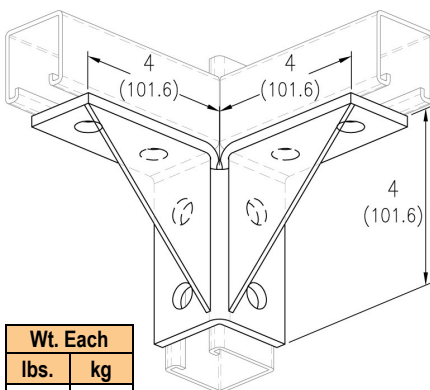

Wt. Each	
lbs.	kg
2.17	(.98)

**FIG. 5675**

10-HOLE GUSSETED DOUBLE CORNER CONNECTOR

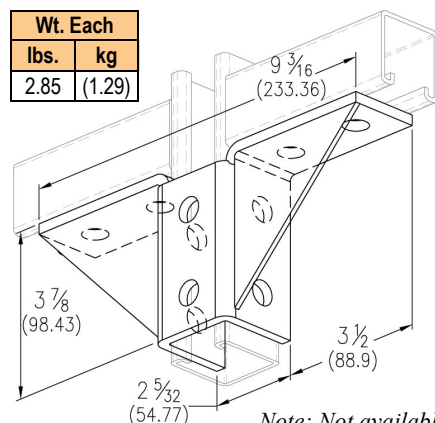

Wt. Each	
lbs.	kg
2.85	(1.29)

Note: Not available in Stainless Steel.

**FIG. 5685**

8-HOLE GUSSETED DOUBLE CORNER CONNECTOR

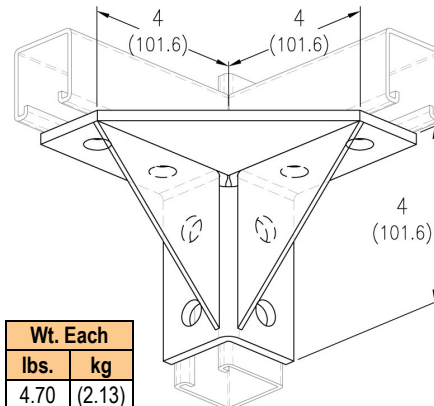

Wt. Each	
lbs.	kg
4.70	(2.13)

Note: Not available in Stainless Steel.

Standard Product Information for 1 1/8" (41.3) width series channel fittings (Unless Otherwise Noted)

Hole Diameter: 9/16" (14.3); Hole Spacing-From End: 1 1/16" (20.6); Hole Spacing-On Center: 1 7/8" (47.6); Width: 1 1/2" (41.3); Thickness: 1/4" (6.4)  
 Material: Carbon steel (Type 304 or 316 Stainless Steel upon request); Finish: Electro-galvanized (hot-dip galvanized, e-coat, and powder coated upon request)  
 Ordering: Specify figure number, material, and finish.

Unless otherwise specified, all dimensions on drawings and in charts are in inches and dimensions shown in parentheses are in millimeters.